

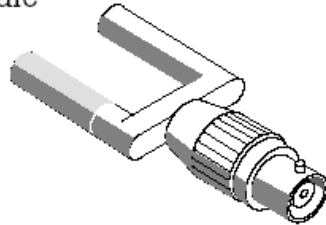

male



female

PM 9081/001***Safety-Designed Dual Banana Plug to Female BNC Adapter***

The set consists of two adapters. One red (signal) and one black (ground) 4 mm (0.15") banana contact.

Maximum Signal Voltage:

300V rms CAT III,
per EN61010-2-031

Maximum Voltage to Ground:

600V rms CAT III,
per EN61010-2-031



female

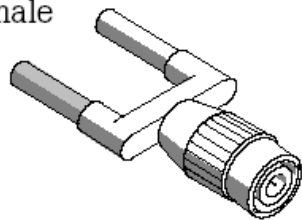

male

PM 9082/001***Safety-Designed Dual Banana Jack to Male BNC Adapter***

The set consists of two adapters. One red (signal) and one black (ground) 4 mm (0.15") banana contact.

Maximum Signal Voltage:

300V rms CAT III,
per EN61010-2-031

Maximum Voltage to Ground:

600V rms CAT III,
per EN61010-2-031

BB120 Shielded Banana to BNC Adapter is required to adapt to ScopeMeter 120 Series shielded banana jack inputs.